

**SINGLE LOCK BOLLARD GENERAL ASSEMBLY-
SIDE VIEW**
SCALE 1: 10

- NOTES :**
1. After fabrication provide rust preventative coating to bare metal & powdercoat in 'Safety Yellow'.
 2. Remove all burrs & sharp edges.
 3. Place reflective tape to top of bollard, as shown in Photo 1 & 3, typical.
 4. Bollard must only be used in a concrete shared pathway or access track. Concrete pad surface must be level with pathway.
 5. An unobstructed continuous path of travel (1.0M minimum width) is required around bollards on shared pathways.
 6. Handles and Lock Housing must point into path of travel, and not obstruct pathway user access.
 7. Use padlocks with weather cover.

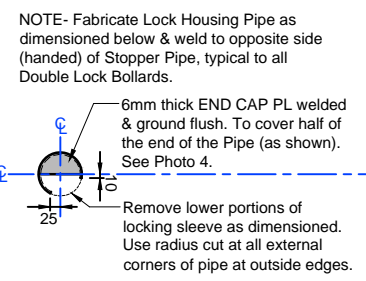

**LOCK HOUSING PIPE DETAIL-
FRONT VIEW**
SCALE 1: 10

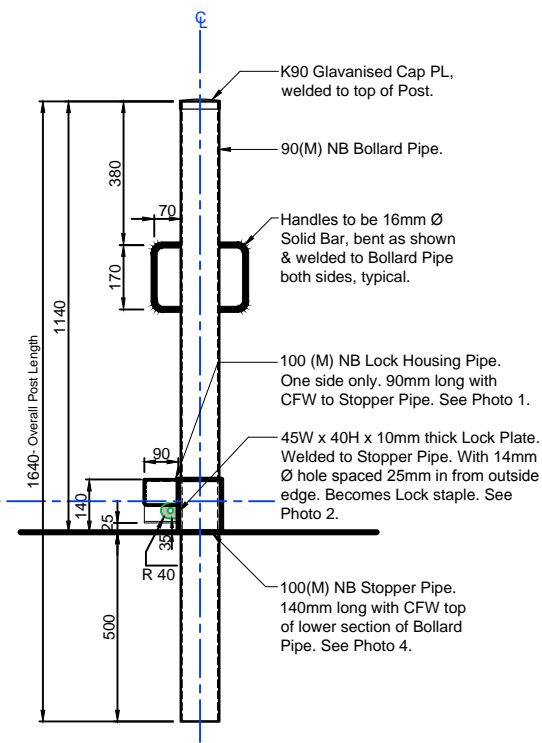

**SINGLE LOCK BOLLARD DETAIL-
SIDE VIEW**
SCALE 1: 10



Photo 1
TYPICAL SINGLE LOCK BOLLARD – SIDE VIEW.
BOLLARD INSTALLED IN SLEEVE CAST INTO CONCRETE SHARED PATHWAY.



Photo 2
TYPICAL SINGLE LOCK BOLLARD – FRONT VIEW. LOCK MECHANISM (HINGED HASP LIFTED OVER LOCK PLATE STAPLE, THEN PADLOCKED).
NOTE: HALF END CAP MISSING, DEMONSTRATION ONLY

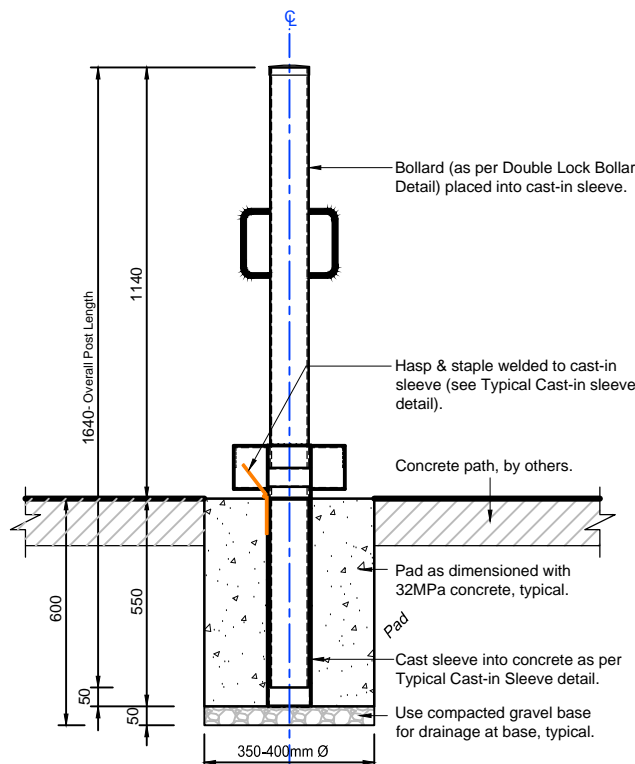

**DOUBLE LOCK BOLLARD GENERAL ASSEMBLY-
SIDE VIEW**
SCALE 1: 10

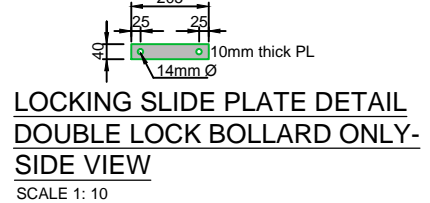

**LOCKING SLIDE PLATE DETAIL
DOUBLE LOCK BOLLARD ONLY-
SIDE VIEW**
SCALE 1: 10

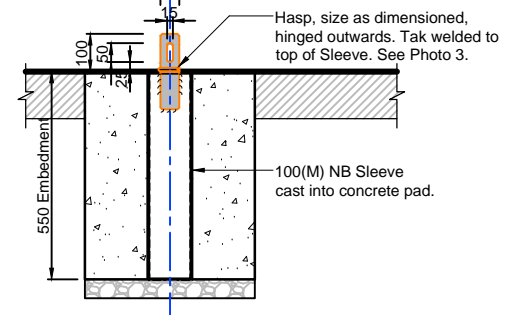

**TYPICAL CAST-IN SLEEVE DETAIL
FOR SINGLE OR DOUBLE LOCK BOLLARD-
FRONT VIEW**
SCALE 1: 10

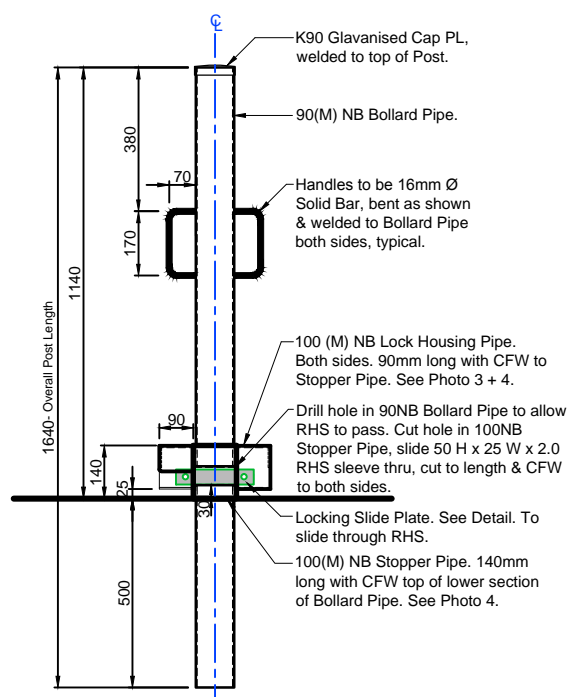

**DOUBLE LOCK BOLLARD DETAIL-
SIDE VIEW**
SCALE 1: 10



Photo 3
PARTS (SIDE VIEW):
1. TYPICAL CAST-IN SLEEVE, WITH HINGED HASP WELDED AT TOP.
2. LOCKING SLIDE PLATE (FOR DOUBLE LOCK BOLLARD).
3. TYPICAL DOUBLE LOCK BOLLARD.

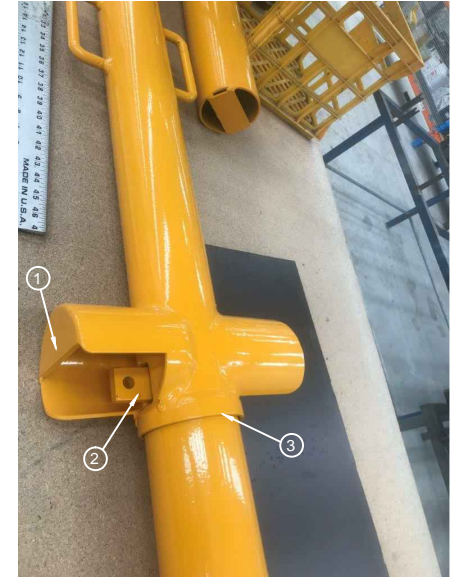

Photo 4
TYPICAL DOUBLE LOCK HOUSING FEATURES:
1. TYPICAL LOCK HOUSING END CAP AND CUT OUT.
2. LOCKING SLIDE PLATE INSERTED THROUGH BOLLARD PIPE.
3. STOPPER PIPE.



FOR CONSTRUCTION

TC 9 Nov 2020 9:01 PM - T:\TMC\1\20-028- Melb Water Details\Bollards_ Rev A.DWG

ISSUED FOR CONSTRUCTION	GMHS	TM	9.11.2020
DESCRIPTION	COMPANY	PROJECT OR WO NUMBER	DATE
REV	DESCRIPTION	COMPANY	DATE

PROJECT OR WO NUMBER	DRAWN	ENG. CHECK	PR. MAN. APP'D	DATE

COPYRIGHT
Copyright - This document is the property of Melbourne Water. Use or copying of the document in whole or in part without the written permission of Melbourne Water constitutes an infringement of copyright.

DRAFTER	DESIGNER	DESIGN MANAGER APPROVAL	PROJECT MANAGER APPROVAL
T. Michaels	-	-	-
DRAFTING CHECK	ENGINEERING REVIEW		
B. Michael	-		

TITLE SINGLE & DOUBLE LOCKING BOLLARD FOR SHARED PATHWAY

GENERAL ARRANGEMENT

PROJECT DATUM	Original Size	MELBOURNE WATER CORPORATION	
Project Datum	A1	G	GS/FEN/016
SCALE	1:100	CODE	MVC DRAWING NUMBER
			REV