

# Edithvale-Seafood Wetlands Discovery Centre

Technical Reference Group  
Meeting No. 5

20 March 2007



# Agenda

- Welcome and Apologies
- Minutes of Last Meeting
- Project Status/EPBC Decision/Site Survey
- Discussion on Interpretative Elements
- Next Steps
- Questions
- General Business
- Next Meeting

# Project Status

- Decision received on EPBC Act referral from DEH – Discovery Centre is not a controlled action, but a number of constraints were placed on the decision as ‘prescribed manners’
- Engineering consultants Connell Wagner have been appointed to provide technical assistance to the project (soil analysis, structural engineering and design, mechanical and electrical services design, document preparation)
- Site survey and associated CAD drawings produced
- First draft of site location of key elements prepared

# EPBC Act Referral Decision

## *Prescribed Manner*

1. Undertake geotechnical investigations to determine extent of peat layer and soil parameters.
2. Appropriate engineering techniques to avoid intrusions into peat layer. Where intrusion is unavoidable, undertake mitigating options such as sealing.
3. Manage acid-sulphate soils in accordance with EPA requirements.
4. External construction works of centre and surrounds must occur during autumn and winter months to avoid disturbance to migratory waterbird species.
5. Facility to utilise non-reflective glass and minimal lighting. Interpretative elements operational only during business hours.

# EPBC Act Referral Decision

## *Prescribed Manner*

6. External lighting limited to that essential for security and public safety purposes. Any external lighting to be baffled and downcast to avoid light over Edithvale South wetland. Car parking designed as far as possible to avoid direction of headlights into wetland areas. Signage to indicate use of low beam, and turning off lights when safe to do so.
7. Activities involving loud or sudden noises (exceeding 10 dB above night background noise at 100 metres from the source) likely to disturb migratory waterbirds, must not occur after 9:00pm during period 1 January to 28/29 February each year.

Top of Bench

# TITLE, FEATURE & LEVEL SURVEY C/T VOL.9581 FOL.650 PROPOSED WETLANDS DISCOVERY CENTRE EDITHVALE ROAD CHELSEA HEIGHTS

SCALE 1:500

Co-ordinate Datum: National (Aligned with Title)  
Level Datum: Australian Height Datum (A.H.D.)  
Yield: P11 SEP (Lyndhurst) @ RL 0.332  
Contour Interval: 200 mm  
(Note: 100 mm Contour Interval in "Wetlands Area")  
Bench Marks established in this Survey were correct at the date of observation.  
Future Bench Mark stability is subject to elements beyond our control.  
Title / Fence relationship has been exaggerated for the sake of clarity.  
This Plan must be read in conjunction with the relevant report.



LOCALITY DIAGRAM  
Utility References: 95 E7

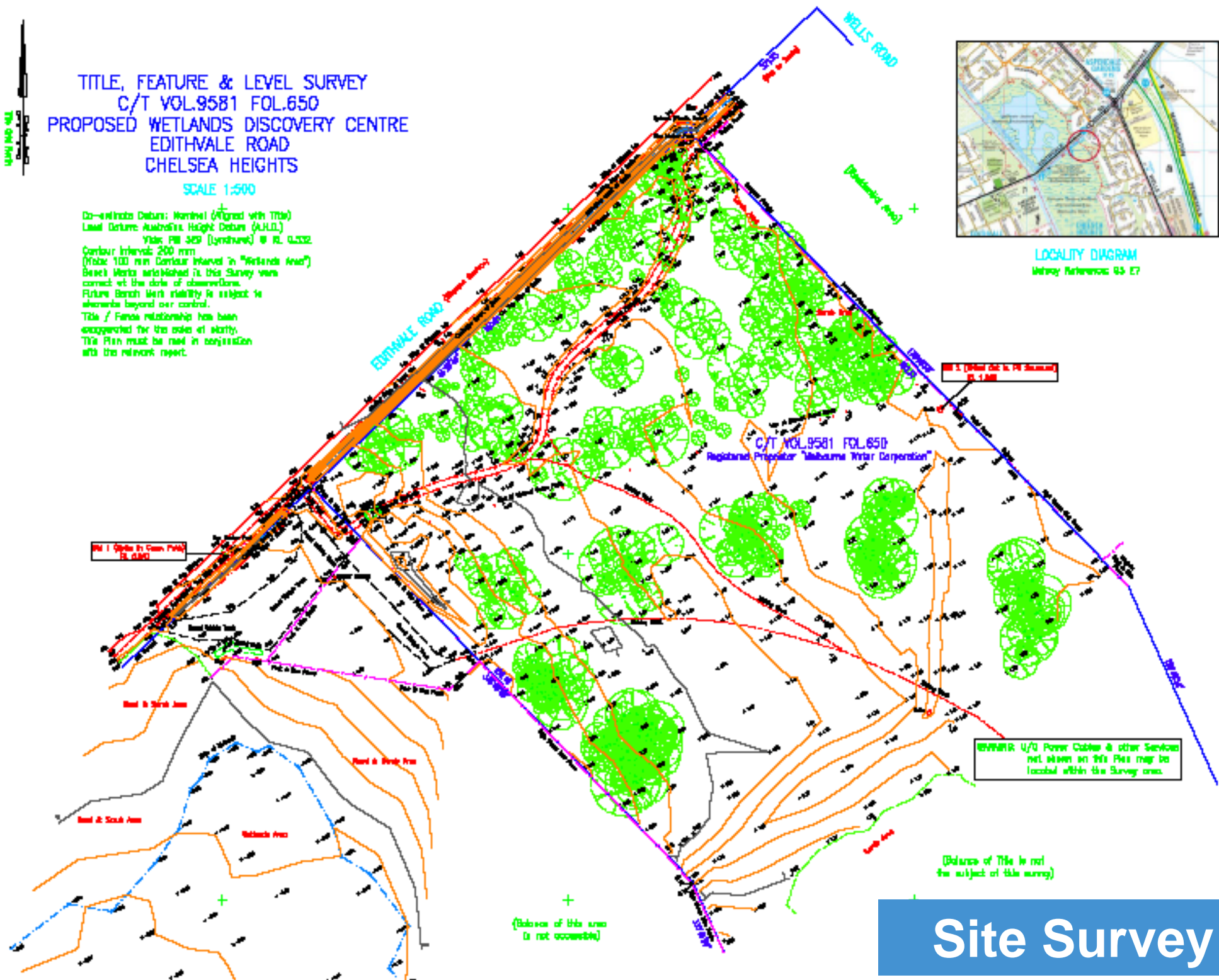

(Balance of Title is not the subject of this survey)

(Balance of this area is not accessible)

# Site Survey

# Concept Site Layout

- Building moved approx 15m closer to wetland, and still outside 120m from -0.3m AHD limit (our RAMSAR guidelines say 60m)
- Building sited at end of existing cleared 'carpark' area
- Existing carpark is replenished as landscape foreground – possibly a new 'constructed wetlands', depending on soil conditions
- Ramp up to AHD +1.85 AHD
- Carpark moved further from housing. Was 40m, now at least 50m

# Concept Site Layout



# Interpretative Elements

- Cunningham Martyn Design (CMD) will be engaged to undertake development of interpretative elements
- Melbourne Water would prefer to have a small working group led by Salyana Williams to be involved in the detail of the interpretative elements, and report back to the Technical Reference Group
  - Salyana Williams (Melbourne Water)
  - Paul Minifie
  - CMD
  - Jane Satchwell
  - One other Technical Reference Group Member

# Interpretative Elements

- Topics suggested for display:
  - Water Cycle
  - Role of Wetlands
  - Importance of ESW
  - Flora and Fauna
  - Indigenous History
  - European History
  - Information on/from various groups – Birds Australia, FoESW, Schools
- Other suggestions from Reference Group?

# Next Steps

- Assess impact on final referral decision from DEH
- Finalise geotechnical reports
- Finalise concept sketches for presentation to next Technical Reference Group meeting
- Form sub-working group for interpretative elements, and commence scoping works
- Prepare preliminary planning permit application

Thank you

